

SOMAcorrect Xtra

NARROW TO LARGE PENILE DIAMETER
+ PEYRONIE'S

1



NHS Code: 15111 Number
PIP Code: 317-5593



5 YEARS WARRANTY

SOMAerect Response II

MEDIUM TO LARGE PENILE DIAMETER

2



NHS Code: 15019 Number
PIP Code: 313-5585



5 YEARS WARRANTY

3 with XL Cylinder

(8" length) WIDE PENILE DIAMETER

£239 including VAT + £8 P&P

NHS Code: 15888 Number
PIP Code: 317-5585 (5 YEARS WARRANTY)

100% Refund within 90 days.
Lifetime Warranty (10 component part
replacement limitation).

4 XLL Cylinder

(11" AVAILABLE ON REQUEST)

DEVICE CONTENTS:

One-piece manually operated device with Large (L - 8 inch), Medium (M) and Small (S) cylinder sizing options. 3 Sizes HIGH tension 'Ultra' Rings, 3 Sizes MEDIUM tension super-comfort 'Ultimate (SureFit)' rings, 3 Sizes HIGH tension 'Select' Rings, 4 sizes PRACTICE 'SureEase' rings, 2 Sizes 'SureRelease' rings, 2 cushioned inserts, Ultra-Ease Ring loading System, lubricant (142g), instruction DVD and guide-book (ED - Peyronie's on request). Travel bag.

£299 including VAT + £8 P&P

100% Refund within 90 days. Lifetime Warranty
(10 component part replacement limitation).

DEVICE CONTENTS:

One-piece manually operated device with Large (L - 8 inch) cylinder sizing option. 3 Sizes HIGH tension 'Select' Rings, 4 Sizes easy removal PRACTICE 'SureEase' rings, 2 Sizes 'SureRelease' rings, 2 cushioned inserts, ring loading cone, lubricant (142g), instruction DVD and guide-book (ED only). Free sample 'Ultimate Surefit' "Y" ring. Travel bag.

£219 including VAT + £8 P&P

100% Refund within 90 days. Lifetime Warranty
(10 component part replacement limitation).

iMEDicare



Manufactured by
Augusta Medical
Systems USA

NHS Prescription? Ask Pharmacy to call: 01923 23 77 95.
Private Order? Just call: 01923 23 77 95.

UK / RoI Distributors: iMEDicare Ltd, Freepost
RTSJ-HHAY-GRXC, Unit 11, Shakespeare Industrial Estate,
Shakespeare Street, Watford, Hertfordshire WD24 5RR
(contact@imedicare.co.uk)

Manufacturer: Augusta Medical LLC, 1027 Broad St,
Augusta, GA 30901, United States. www.augustams.com.
EC REP: CPartner4U, Esdoornlaan 13, 3951 DB Maarn,
The Netherlands, www.cepartner4u.com,
office@cepartner4u.com
UKRP: UKCApartner4U Ltd., 7 Campion Way, Bingham,
Nottingham NG13 8TR

THE CROSS CATEGORY SUCCESS RATE OF THE VACUUM THERAPY IS AT ABOUT 90% [TABLE 1]

Study Derouet et al (1999, Austria) [2]

METHOD: Clinical monitoring was carried after 0.7 to 6 years by sending 54 vacuum therapy acceptors (age 37-79) a questionnaire and carrying out a clinical follow-up examination.

RESULTS: Patients, who used the vacuum therapy successfully for longer than 4 months, generally continued the therapy. Only 8 of 54 patients discontinued the therapy after on average a period of 10.5 months. (Fig. 1). The reasons for that were loss of the partner, deterioration of health, spontaneous improvement of the erection and only partly the method itself. On average, the patients required 4.3 minutes to create an erection and they could sustain this on average for 13.7 minutes. 73% of the patients had a sexual climax and for 58.6% the ejaculation was, in spite of using an erection ring, always or mostly normal. The rate of overall satisfaction of the 46 long-term users was at 98%, and was thereby slightly higher than for their partners with 85% (Fig. 2). There were no serious complications. 60% of the patients reported never having had any side effects.

Fig. 1 Discontinuation rate of the vacuum therapy (n=54)

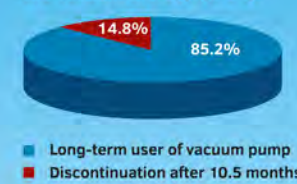

Fig. 2 Satisfaction rate of the vacuum therapy (n=46)

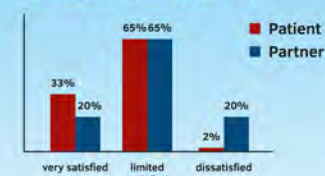

TABLE 1: Cross sectional overview of vacuum erection device important historical studies

Author	Publication	Number of Patients	Extent	Results
Nadig et al. [3]	1986	35	8 - 22 months	> 90% reach an erection sufficient for sexual intercourse 68.6% satisfaction and regular use of the vacuum pump
Witherington [4]	1989	1517	8.6 months	92% reach an erection sufficient for sexual intercourse
Cookson et al. [5]	1993 USA	115	29 months	> 90% satisfaction with the quality of the erection (hardness, length, girth) 84% patient and 89% partner satisfaction, 70% regular application
Baltaci et al. [6]	1995 GB	49	12.8 months	80% satisfaction rate, 67% effectivity rate 88% success rate for arterially caused erectile dysfunction
Lewis et al. [1]	1997 USA	5847	?	83.5% regular use of the vacuum pump

TABLE 2: Reduction in penis size after radical prostatectomy with and without the use of a vacuum erection system

Author	Publication	no vacuum therapy, %	with vacuum therapy, %	Follow-up (months)
Munding et al. [10]	2001	71	n/a	3
Savoie et al. [11]	2003	69.3	n/a	3
Zippe et al [12, 13]	2006/2007	62.8	23	9
Kohler et al. [14]	2007	45.4	12	6
Dalkin [15]	2007	n/a	3.5	3
Monga et al. [16]	2006	62	0.27	12

- ✓ DISCREET SHIPPING
- ✓ 90 DAY MONEY BACK GUARANTEE
- ✓ STANDARD LIFETIME WARRANTY (1)
- ✓ INSTRUCTIONS & ACCESSORIES INCLUDED
- ✓ DEDICATED CUSTOMER SUPPORT & DEVICE USE TRAINING (2)

- 1) Subject to 10 component part replacement limitation: Pump head and Cylinder only.
- 2) Free one-to-one Televideo Support or Hospital Clinical Appointment or Home Visit - location dependent.



INTRODUCING SOMAerect VACUUM ERECTION TECHNOLOGY

Successful in over 92% of cases, (8% of users are either contra-indicated or lack sufficient dexterity) SOMAerect Vacuum therapy is the drug-free, natural way to restore intimacy within seconds - giving you total control over the timing and duration of your erection. Fully customizable, SOMAerect next generation technology enables you to induce full penile engorgement comfortably every time and promote good penile health.

In fact, regular use often leads to a full return of natural erectile function. Already used by millions of men worldwide, SOMAerect products can be used in complete safety with 100% consistency as many times per day as needed.

ASK FOR A FREE TRIAL AND HOME DEMONSTRATION

Simply call: **01923 23 77 95** to find out how to arrange a free home visit, tele-video appointment or a hospital demonstration in your local urology or diabetes department.

Our highly experienced technicians (over 60,000 demonstrations UK and Ireland-wide) will advise you in complete confidentiality how to use your SOMAerect Vacuum Therapy device to best effect and of course customize the device to your own personal requirements.

AVAILABLE ON NHS PRESCRIPTION

All SOMAerect Vacuum Therapy devices for Erectile Dysfunction are available on NHS Community FP10 prescription from your GP (subject to Schedule II restrictions - see part IXA Drug Tariff - Appliances* and local prescribing restrictions, in most CCG areas).

For more information or to order your SOMAerect system privately (discrete home delivery) - please call: **01923 23 77 95** or email: contact@imedicare.co.uk. NHS Prescriptions can be dispensed via your local Pharmacy (Orderline: **01923 23 77 95**, or email: orders@imedicare.co.uk).

*To qualify for an NHS FP10 prescription, marked SLS, you must have or had at least one of the following medical conditions: Diabetes, Prostate Cancer, Prostatectomy, Multiple Sclerosis, Parkinson's Disease, Poliomyelitis, Radical Pelvic Surgery, Severe Pelvic Injury, Renal Failure treated either by Dialysis or Transplant, Single Gene Neurological Disease, Spinal Cord Injury, or Spina Bifida.

DRUG FREE, AS NATURE INTENDED...



MyPelvicHealth.co.uk



01923 23 77 95



iMEDicare Ltd

Unit 11
Shakespeare Industrial Estate
Shakespeare Street
Watford WD24 5RR

contact@imedicare.co.uk

SOMAerect SLS

Penile Structural Rehabilitation

Supported by

PENILE VACUUM THERAPY

WHAT IS ERECTILE DYSFUNCTION?

The inability to engage in sexual relations with your partner (*erectile dysfunction*) can affect up to **1 IN 10 MEN** and becomes more common with age, especially for those with conditions such as diabetes, high blood pressure or cardiovascular disease. Concern about the loss of manhood or the role of sexual intimacy in your relationship can cause a great deal of distress and reduced quality of life to those affected. However, in today's world, erectile dysfunction is treatable.

E.D. SOLUTION

HOW CAN VACUUM THERAPY HELP?

SOMAerect Vacuum Therapy is the safest and most consistently successful non-invasive treatment option for your E.D. problem, applied in a totally natural way. Clinically proven to work for over 92% of men, iMEDicare's SOMAerect Vacuum Therapy has none of the unpleasant side-effects associated with drug therapies (*headaches, visual disturbances etc.*) and is much more cost effective over the longer term.

Plus, you can use your SOMAerect system as often as you want.

HOW DOES IT WORK?

The penis is positioned inside the device cylinder. Pumping periodically over a 1-3 minute period pulls blood into the penis creating a fully rigid erection. An Erection Maintenance Ring is transferred from the device cylinder to the base of the penis against the body wall. Removal of the cylinder allows full sexual intercourse to take place. The ring will hold the erection fully firm for **UP TO 30 MINUTES** at a time, even after orgasm, and permit ejaculation escape in almost all cases.

The erection will subside with removal of the ring. This process can be safely repeated again within a few minutes as often as required per day.

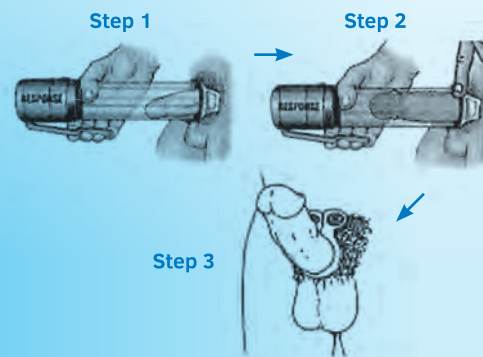

SOMAerect **SLF**

ULTRA LIGHT-WEIGHT, COMPACT AND EASY TO USE

SOMAERECT DEVICE FEATURES AND BENEFITS:

- 1 ULTRA-EASE Easy-Slide Ring Loading System
- 2 Effortless 'One-Finger' Manual Pumping Control
- 3 Manual Vacuum Release Button and Automatic Cut-Out when Fully Erect
- 4 Four Variable Diameter Cylinder 'Sizing-to-fit' Options (Drop Resistant)
- 5 Telescoping Cushioned Inserts
- 6 Powerful Yet Super-Quiet Battery
- 7 Five Ring Types With Up To Four Sizes
- 8 Single-Use SureRelease Fertility Ring-Tear Apart at Ejaculation (Two Sizes)

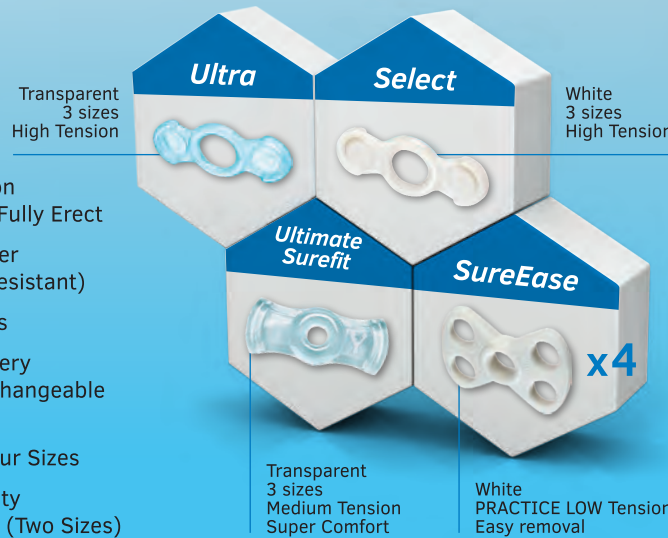

SOMA-THERAPY AS A 'PENIS GYM'

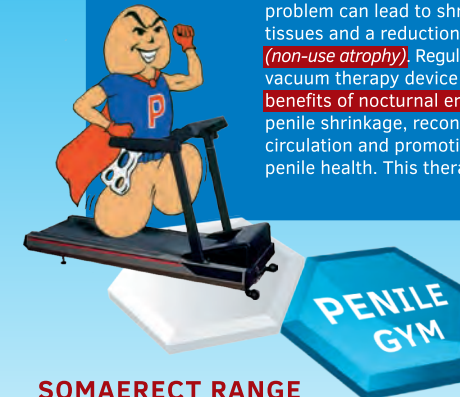

It is recognised that a prolonged erection problem can lead to shrinkage of the penile tissues and a reduction in penile circulation (*non-use atrophy*). Regular use of a SOMAerect vacuum therapy device will **duplicate the benefits of nocturnal erections**, reversing penile shrinkage, reconditioning penile circulation and promoting a return to good penile health. This therapeutic benefit of

regular device use is perhaps best understood as the SOMAerect '**Penis GYM**' concept. In other words, we can talk in terms of regular device use equating to penile 'exercise' with a resulting improvement in penile 'fitness'. Published clinical studies have shown that "patients who underwent daily vacuum therapy usage, showed, at the end of the (6 mths) treatment, a significant improvement

in spontaneous erectile ability". Of 1,517 patients prescribed vacuum therapy and participating in a follow-up survey, 25% credit the therapy as allowing them to perform occasionally without the use of an aid, and 17% credit the therapy with full restoration of natural potency.

(*J Urology 141 (2): 320-2, February 1989.*)

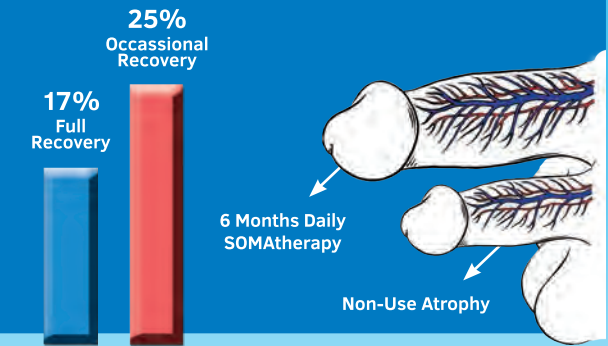

SOMAERECT RANGE

The SOMAerect product range represents the new generation of uniquely customizable vacuum therapy systems for restoring penile health. They combine the latest technological advances in the field with a sleek attractive design that is amazingly simple to use. **The effortless ultra-ease pumping action offers a powerful but gentle way of inducing full penile rigidity every time.**

THE IMPORTANCE OF 'SIZE TO FIT'

The SOMAerect product range uniquely offers 5 cylinder sizing options so you can almost precisely find the diameter sizing option that neatly fits your fully rigid penis size. This prevents loose non-penile tissue from around the base of the penis (supra-pubic fat or scrotal skin) being drawn into the mouth of the cylinder during erection creation and being compressed uncomfortably with the transfer of the erection ring – as would be the case with a conventional vacuum therapy device.

The use of SOMAerect 'sizing' technology guarantees a much more comfortable erection experience. The large range of re-useable erection maintenance rings, exclusive to SOMAerect, gives you an unparalleled choice to guarantee greater comfort and effectiveness in maintaining our vacuum induced erection.

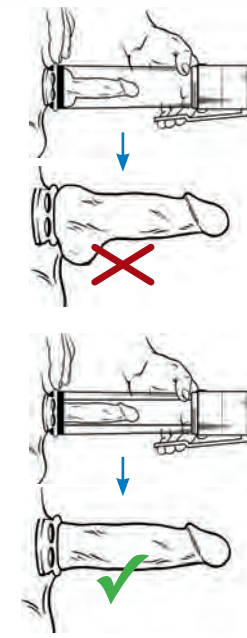

5 CYLINDER SIZES



PENILE STRUCTURAL REHABILITATION FOR MEN WITH PROSTATE CANCER TREATMENT

With a growing number of sexually active patients undergoing radical prostatectomy, the restoration of sexual function has become increasingly important, and the concept of penile rehabilitation following this procedure is now widely accepted in clinical practice. Penile rehabilitation has been defined as the use of any drug or device at the time of or following RP to facilitate the restoration of erectile function.

Randomised Controlled clinical studies have shown that regular use of a Vacuum therapy device following a prostatectomy or other prostate cancer treatment facilitates an early return to sexual intercourse, increased sexual satisfaction, reversal of penile shrinkage, and potentially, an earlier return of natural erections (*this requires that a nerve sparing procedure was carried out successfully*). When **oxygenated blood** is drawn into the penile tissues by a SOMAerect vacuum therapy device, it is believed that the Nitrous Oxide system of the tissue may be enhanced, and hence, help erectile function be restored. It is believed that in these patients low oxygenation is one of the main reasons for vital first messenger deficiencies which contribute to the 'non-use atrophy' of the corporeal smooth muscle (*wall of penile arteries*) and subsequent corporal fibrosis. In one study* in men who had a prostatectomy, and who then used a SOMAerect device on a regular basis (*daily therapeutic 10 minute protocol*), 32% reported a return of natural erections at 9 months, with 17% having natural erections sufficient for vaginal intercourse.

THEORETICAL

- 1) Regular mechanical stress (*exercise*) – improves cellular metabolism/cell division and is anti-apoptotic (*prevents non-use atrophy*).
- 2) Promotes neovasculization
- 3) Oxygenation enhances NO system
- 4) Modulates expression of TGF-beta (*leads to collagen synthesis and tissue fibrosis*)

MECHANISM OF ACTION

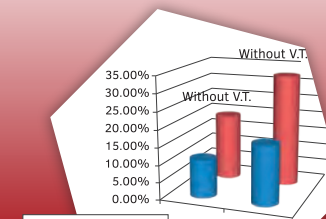

* Impotence Research (2006) 18, 77-81-R Raina, A Agarwal, S Ausmundson, M Lakin, KC Nandipati, DK Montague, D Mansour and CD Zippe.

PROTOCOL DETAILS

- 1 Assessment and device training by iMEDicare Technician 8 weeks post surgery or shortly after radiotherapy.
- 2 Daily SOMAerect Vacuum Therapeutic application for 10-20 minutes for 4 weeks. Daily program: 10-20 full erections consecutively (penis push-up) each sustained for not more than 5 secs in the device cylinder at full engorgement.
- 3 Sexual activity one month after initiation of program.
- 4 Continued therapeutic SOMAerect application alternate days in the longer term.
- 5 Monitoring of progress – spontaneous nocturnal or sexual erections? Full recovery?

Prostate cancer is now the most common cancer in men in the UK. Over 47,000 men are diagnosed with prostate cancer every year – that's 129 men every day. 1 in 8 men will get prostate cancer in their lifetime. Over 330,000 men are living with and after prostate cancer.

VED therapeutic application post-prostatectomy is also well established and supported by the BSSM / MacMillan / PCUK. Regular V.E.D. usage equates to a penile gym effect – oxygenation and mechano-receptor stimulation (*which has an anti-apoptotic effect*) prevents dis-use atrophy (*cavernosal fibrosis*) and reverses penile shrinkage: study showed that vacuum erectile device (VED) therapy has improved erectile function and preserved penile size in rats with bilateral cavernous nerve crush (BCNC) injuries, using blood gas and tissue to samples to establish The beneficial effect of VED therapy is related to antihypoxia by increasing the cavernous blood oxygen saturation.

CE Manufactured by Augusta Medical Systems USA