

āfex Active*

STARTER KIT

	āfex ACTIVE – CONTENTS	VARIANT – BRIEF SIZE ABOVE WAIST MEASUREMENT	NHS CODE
1	1 x High Receptacle	Small (28" – 30")	A100-S-08
2	1 x Briefs (VARIABLE SIZES)	Medium (32" – 34")	A100-M-08
3	1 x Re-useable 500ml Collection Bag	Large (36" – 38")	A100-L-08
4	1 x Cleansing Container	XL (40" – 42")	A100-XL-08
5	1 x Cleansing Solution – 118ml	2X (44" – 46")	A100-2X-08
		3X (48" – 50")	A100-3X-08

COMPONENTS



BLACK BRIEF OPTION
PRESCRIBABLE
SEPARATELY

	āfex CORE SUPPORTER** – CONTENTS	VARIANT – BRIEF SIZE ABOVE HIP	NHS CODE
1	1 x High Receptacle	Small (28" – 30")	A100S-5105-C
6	1 x Core Jack-Strap Style Briefs (VARIABLE SIZES)	Medium (32" – 34")	A100M-5105-C
3	1 x Re-useable 500ml Collection Bag	Large (36" – 38")	A100L-5105-C
4	1 x Cleansing Container	XL (40" – 42")	A100XL-5105-C
5	1 x Cleansing Solution – 118ml	2XL (44" – 46")	A1002X-5105-C
	**HIGH PUBIC PRESSURE	3XL (48" – 50")	A1003X-5105-C

āfex Core Supporter*

STARTER KIT

*Available on prescription from your GP or by ordering privately on: MyPelvicHealth.co.uk (+44) 1923 23 77 95

FOR DISPENSATION: Your Pharmacy can order from iMEDicare directly (orders@imedicare.co.uk) or via the "Specials Division" of wholesalers, or simply post your prescription to "FREEPOST PATIENT CHOICE".

Optional Extras (NOT AVAILABLE ON NHS PRESCRIPTION)



SECURE WRAP

1 Pack: £5.95
4 Pack: £20 (save £6.80)



500 ML BAG SLEEVE

1 Pack: £4.95
5 Pack: £20 (save £7.95)



...IS THE ANSWER
WHEN *nature* CALLS...



MyPelvicHealth.co.uk

01923 23 77 95

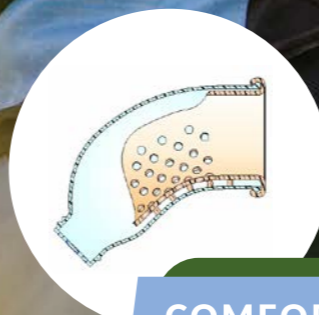

COMFORTABLE

Loose fit, adhesive free receptacle with double-wall design reduces exposure to residual urine.



DISCREET

Briefs conceal system under clothing. Double-sealed collection bag effectively contains odour.



FIGHTS ODOUR, RASH & EMBARRASSMENT



CONVENIENT

Collection bag connects simply with our twist 'n' lock design and easily drains with our one-touch port.

- ✓ COMFORTABLE
- ✓ CONVENIENT
- ✓ COST-EFFECTIVE

ADHESIVE-FREE EXTERNAL COLLECTION SYSTEM FOR MEN

POST-PROSTATECTOMY MANAGEMENT OF STRESS INCONTINENCE

» FREEDOM TO LIVE – CHOOSE LIFE NOT LEAKS

Available on prescription



iMEDicare Ltd
Unit 11
Shakespeare Industrial Estate
Shakespeare Street
Watford WD24 5RR
contact@imedicare.co.uk



UKRP & EU REP: Eurolink (Europe) Ltd, Avalon House
Marcham Road Abingdon, Oxon OX14 1UD, UK
Manufacturer: Arcus Medical, 2327 Distribution Street
Charlotte, NC 28203 USA



Active & Core Supporter

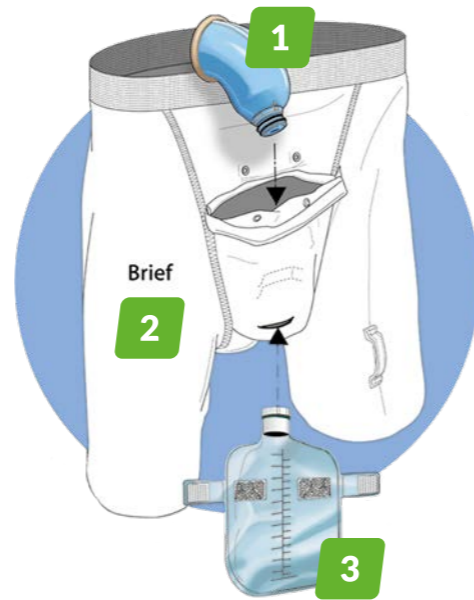

EFFECTIVE SUPPORT

The afex system makes managing post-prostatectomy stress incontinence easier and more dignified than ever. The 96% cotton boxer briefs discreetly and securely hold a plastic (PVC) curved receptacle inside a front pocket that channels urine into a standard 500ml reusable collection bag (12ml vinyl – 4 to 6 week lifespan).

Uncomfortable tubes or straps are not required – just attached the bag directly to the receptacle through the briefs for hours of use without maintenance or changing.

The outdoor systems shown here (afex Active & afex Core Supporter) can be used for active daytime use such as golfing, fishing, hiking, bowling, walking, gardening, or travelling or any general out-door activity.

It has three main components:

1. An Ergonomic Receptacle
2. Boxer Briefs (or jock strap style briefs with afex Core)
3. A Collection Bag

Receptacles are available in 2 styles, high and low. Briefs are based on waist / hip size.

Collection bags come in:

- ✓ 250ml size
- ✓ 500ml size (vented for sports, or unvented as standard)
- ✓ 1500ml size

The annual cost of afex to the NHS can be as low as £160, given the durability of components.

afex Urine Collection (thigh) Bags*	NHS CODE
250ml Bag	A400S
500ml Bag	A400-B-08
500ml Vented Bag	A400-V-08
1500ml Extra Capacity Bag	A400-E-08

*30 – 40 day lifespan with continuous use.

Order your kit today!



FREE SAMPLE and home assessment available on request.

Why Choose afex?

USER SUCCESS REQUIRES:

- Flaccid penis to dangle over the testicles when seated**
- Reasonable manual dexterity**
- Sound Cognition**

DOUBLE WALLED

inner receptacle lining drains urine away from the penis, helping to keep skin dry – recovery from sheath excoriation or pad rash.

PUBIC PRESSURE

to hold the receptacle against the body wall comes from a tight but comfortable stretch brief (4% Lycra) with hip band.

SECURE POSITIONING

of the penis centrally within the receptacle by padded secure wrap hugging the shaft of the penis at the open end of the receptacle.

Wrap absorbs splash-back and prevents “popping out” with active movement.

Shape Retaining Latex-Free Receptacle

Comfortable 96% Cotton Jockstrap Style Brief

Direct Connect PVC Bag

Top Bottom

Top Bottom

- BENEFITS**
- ✓ No adhesives used
 - ✓ Receptacle is breathable with natural relaxed fit
 - ✓ Complete system is latex free
 - ✓ Simple three part system comes ready to use
 - ✓ Double-wall receptacle keeps skin away from urine
 - ✓ Receptacle with direct-connect bag is fast flow capable
 - ✓ Pressure-free collection bag with activity tabs

